

# STACKED WOOD

## Ceiling Plank Installation of our Stacked Wood Ceiling Planks using the Direct Track System

### PRECAUTIONS

Always wear work gloves and safety glasses when cutting the product. Read the installation instructions and warranty before getting started.

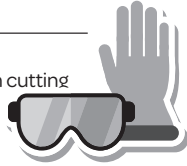

Stacked Wood guarantees the conformity of its products when they are installed according to the installation instructions and are maintained in an environment where ambient humidity ranges between 35% and 55%. Failure to comply with installation instructions shall void the application of the Warranty.

LEAVE THE BOX FLAT ON THE FLOOR IN ITS ORIGINAL WRAPPING UNTIL INSTALLATION.

## INSTALLATION INSTRUCTIONS

### Tools:

- Cordless drill
- Hammer
- Tin Snips or Hacksaw
- Clamps
- Electric mitre saw
- Drill bit set
- Sawbench
- Level
- Measuring tape
- Utility type knife
- Chalk Line
- Stepladder
- #6 Coarse thread screws

MAKE SURE YOUR KNIVES AND SAWBLADES ARE IN PRIME CONDITION.

### INSTALLING DIRECT TRACK SYSTEM

**STEP 1:** Place the Direct Track opposite the joists. Install the track using #6 coarse thread screws, with screw length depending on your existing ceiling type. For plaster, use 3" screws; for drywall, use 2" screws; for direct attachment to joists, use 1 5/8" screws. (*Note: Screws sold separately*). If needed, you can shim the Direct Track to improve the flatness of your existing ceiling.

**STEP 2:** Screw the first row of track 2" from the side wall, using a screw at every joist. Continue installing the first row of track end-to-end or overlapped side to side, ensuring the track is flush with the front and back walls. To finish a row of track, cut it to fit using tin snips or a hacksaw.

**STEP 3:** Measure the width of the border tile from the side wall and subtract 2".

**STEP 4:** Install a second row of track parallel to the first at that point.

**STEP 5:** Install the remaining rows with a spacing of 12" on center.

**STEP 6:** Install the last track row 2" from the opposite side wall.

By following these installation steps and using the Direct Rail System, you can quickly achieve a stunning and efficient stacked wood ceiling for your space.

The Direct Track system offers a simple and efficient installation method for your Stacked Wood ceiling planks, enabling you to make the most of your ceiling space.

### INSTALLING STACKED WOOD CEILING PLANKS

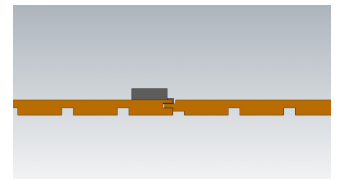
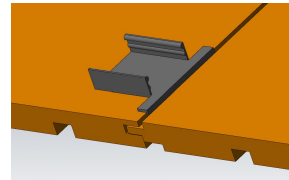

**STEP 1:** Attach Direct Track System to Ceiling

**STEP 2:** Install a guide string along the front wall. Position about 3/4" below the tracks.

**STEP 3:** Familiarize yourself with the flanged edges of the plank before you begin cutting your first plank.

**STEP 4:** Side wall: Cut plank to the side wall border plank width, face-up, with a table saw. Do not cut off the flange sides of the plank.

**STEP 5:** Front wall: Cut plank to front wall border dimension.

**STEP 6:** The flange is not part of the border plank measurement. Measure the face of the plank only.

**STEP 7:** Snap a clip onto the first two tracks, teeth facing out.

**STEP 8:** Push clips flush against the wall.

**STEP 9:** Push the first plank firmly into the corner by embedding clips into the cut edge.

**STEP 10:** Snap two new clips onto tracks and slide teeth over the flange to secure the flange side of plank.

**STEP 11:** Lightly tap clips with a hammer to set the plank tightly to the front wall. Make sure the plank face edge is aligned with the guide string.

### 2nd Border Plank

**STEP 12:** Follow the same procedure as the first border plank, measuring and trimming along the front edge only (not flange edge). Push the flange edge firmly into the first border plank.

### Begin Installing Row Two

**STEP 13:** Trim plank to the side wall border plank width.

**STEP 14:** Install with clips.

**STEP 15:** Slide into place, making sure the face edge is aligned with the plank.

**STEP 16:** Align plank squarely with the adjacent 3 planks. Make sure all face edges are aligned. Install the remaining plank to complete the first row (border). Keep the plank face edge, not the flange edge, flush with the guide string.

**STEP 17:** Continue installing the plank using the diagonal sequence shown.

**STEP 18:** Snap a clip onto the track before inserting the last row of planks, and push flush with the end wall.

**STEP 19:** Cut the border plank against the end wall 1/2" short to allow for expansion as room conditions change.

**STEP 20:** Install end wall border plank and use a screwdriver next to the wall to embed the clip into the cut edge of the plank.

**SPRINKLERS:** If your ceiling is equipped with sprinklers, it is important to be compliant with the building code and other laws applicable to your region. Contact the project planner / fire safety departments.

